

SPARROWHAWK XXT PARTS LIST 零件表

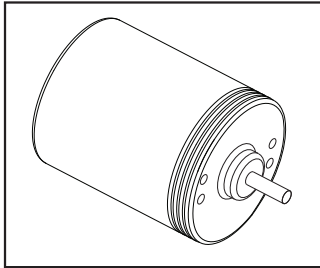

2343 MOTOR IBL 36/39-540C
無刷馬達

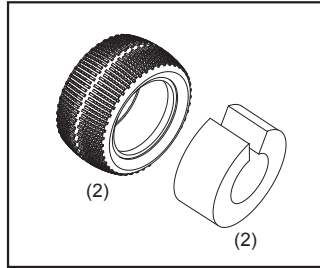

PD6606 TIRES W/FOAM
輪胎零件包

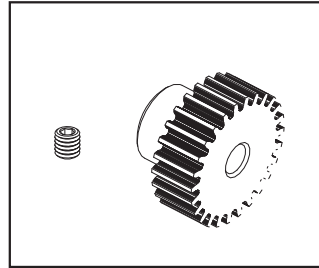

PD7036 22T 48P PINION GEAR
驅動齒輪

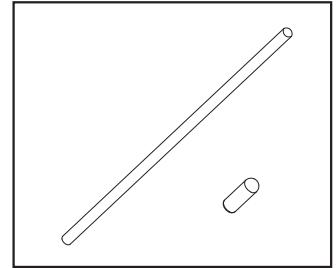

PD7712 ANTENNA BAG
天線管零件包

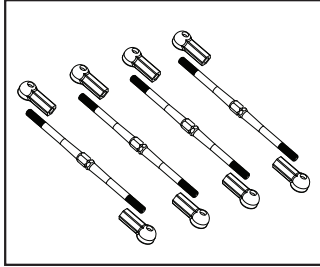

PD7725 CAMBER LINK TIE RODS
拉桿組

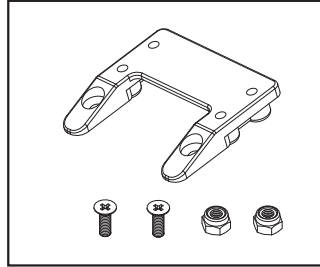

PD7727 WING UPPER MOUNT
上尾翼支架組

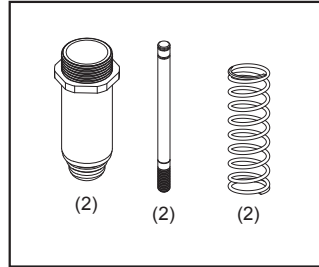

PD7733 FRONT SHOCK REPAIR KIT
避震器維修組(前)

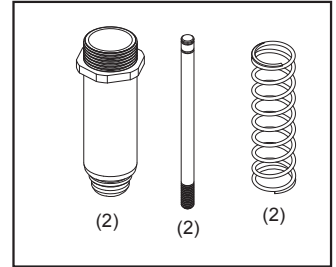

PD7734 REAR SHOCK REPAIR KIT
避震器維修組(後)

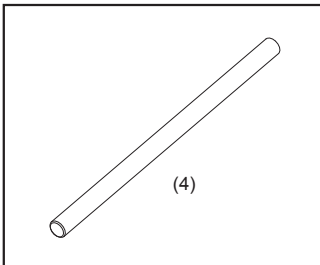

PD7735 INNER HINGE PIN SET
擺臂插銷組

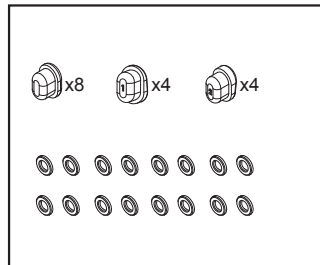

PD7736 SUSP. ARM MOUNT BUSHING
擺臂軸套

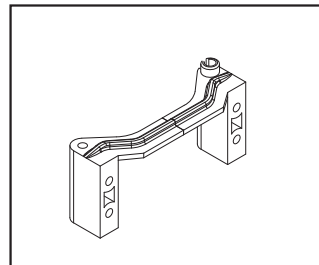

PD7846 SERVO MOUNT, PR
伺服機座

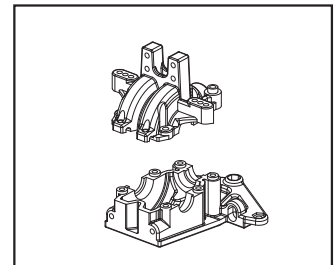

PD7901 FRONT BULK SET
前差速箱上下蓋組

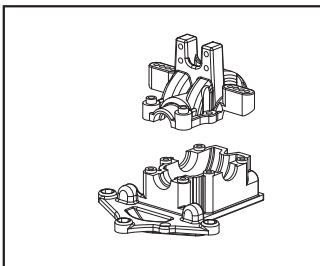

PD7902 REAR BULK SET
後差速箱上下蓋組

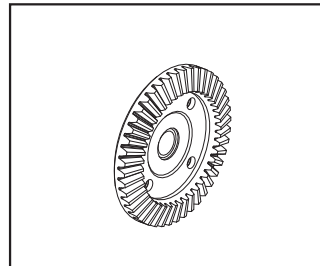

PD7905 DIFF SPUR GEAR 44T
差速大傘齒

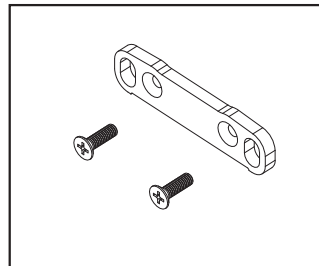

PD7915 FRONT TOE PLATE
前投影板

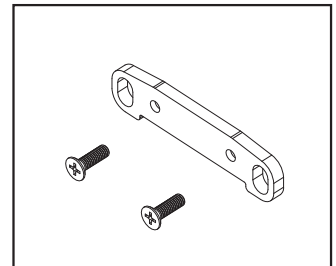

PD7916 REAR TOE PLATE
後投影板

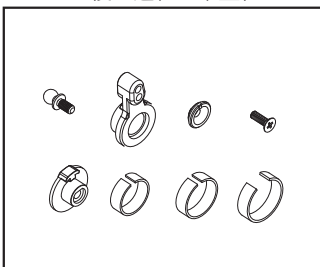

PD7922 STEERING SERVO HORN SET
轉向拉桿緩沖組

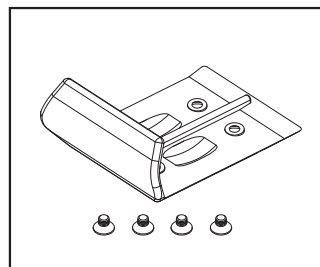

PD7931 BUMPER
前防撞板

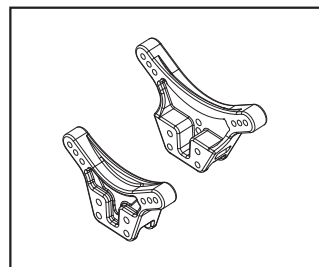

PD7936 SHOCK TOWER SET
避震器支架

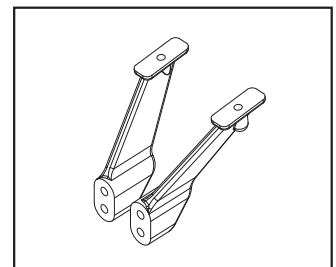

PD7938 REAR WING MOUNT
尾翼支架

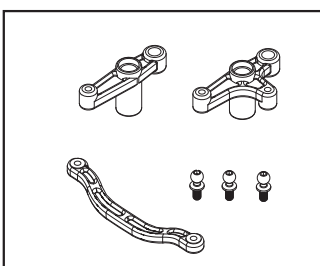

PD7971 SWING RACK SET
轉向曲柄組

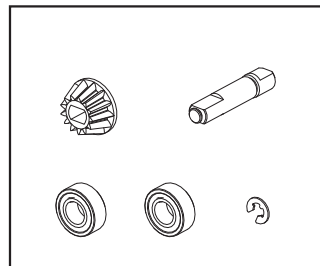

PD7973 DRIVE PINION SET 13T
差速小傘齒

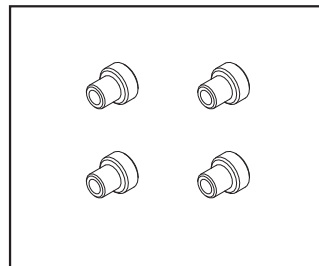

PD7975 SHOCK MOUNT
避震器固定塊

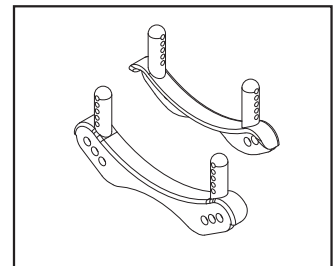

PD7976 BODY POSTS
車殼支柱

SPARROWHAWK XXT PARTS LIST 零件表

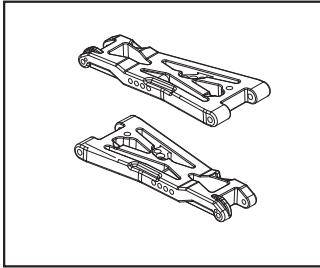

PD7977 FRONT SUSPENSION ARMS
前擺臂組

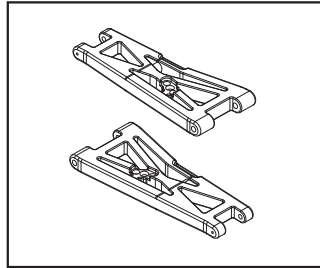

PD7978 REAR SUSPENSION ARMS
後擺臂組

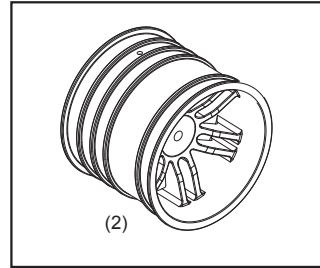

PD7984 TRUCK WHEEL (BLACK)
輪殼組(黑)

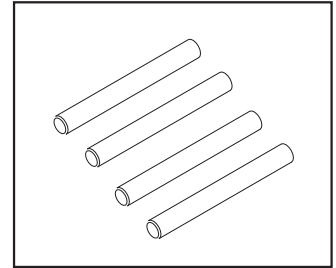

PD7994 INNER HINGE PIN SET
擺臂銷組

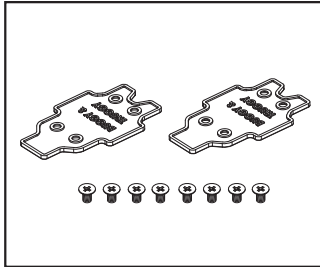

PD7998 BULK LOWER COVER
差速箱下蓋板

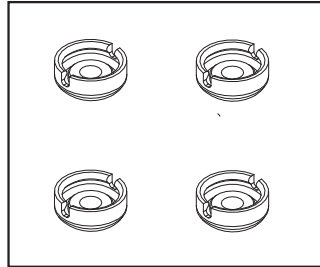

PD8091 SHOCK BOTTOM CAPS
避震器下座組

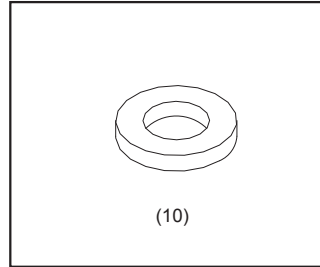

PD8092 SHOCK INNER SPACER
背托環

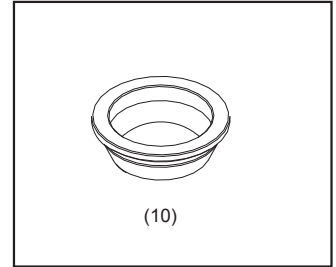

PD8093 SHOCK BLADDER
空氣活門

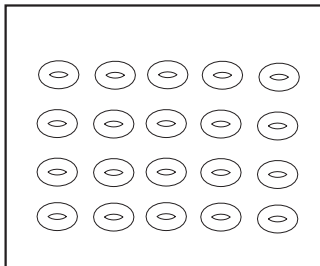

PD8097 SHOCK INN O-RING
避震器下O型環

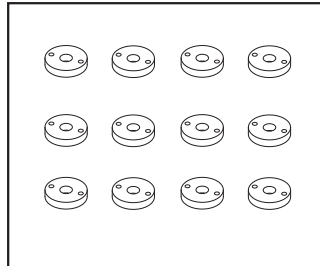

PD8098 SHOCK PISTON
避震器活寒

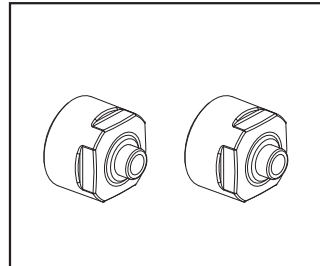

PD9051 DIFFERENTIAL CASE
差速器本體

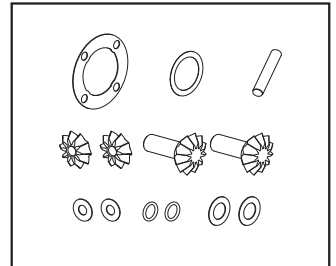

PD9055-1 DIFFERENTIAL GEAR SET
差速器齒輪

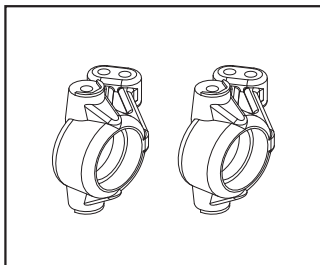

PD9077 STEERING BLOCK SET
轉向臂

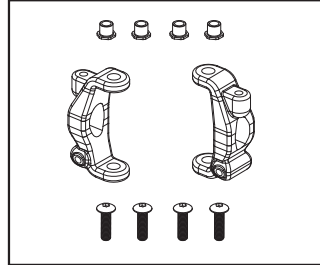

PD9078 CASTER BLOCK SET
C型座組

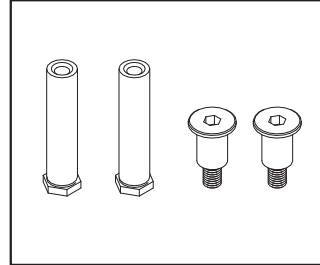

PD9087 SWING POST SCREW
轉向軸

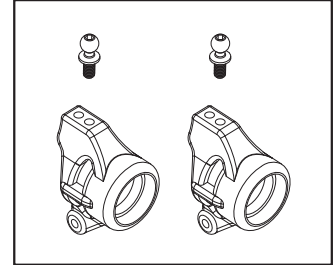

PD9090 HUB CARRIER SET
後輪座

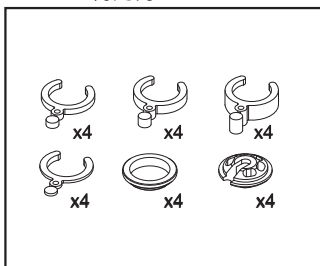

PD9102 SHOCK ACCESSORIES
避震器配件

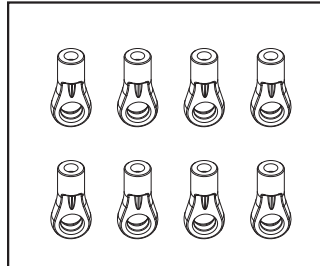

PD9103 SHOCK EYELET
避震器球頭拉桿

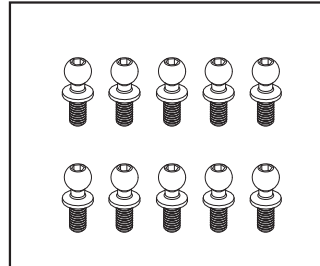

PD9104 BALL STUD
球頭座

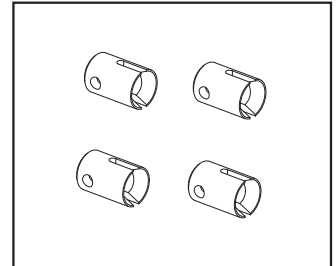

PD9201 OUTDRIVE CUPS
傳動軸套

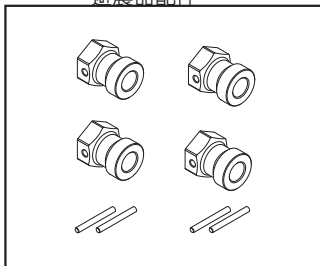

PD9203 ALUMINUM HEX DRIVE
鋁合金輪殼轉換器

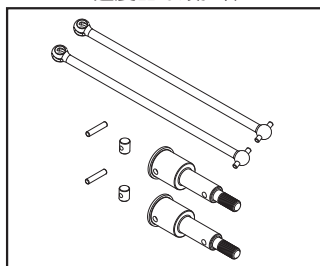

PD9204 FRONT UNIVERSAL SHAFT
前輪傳動軸

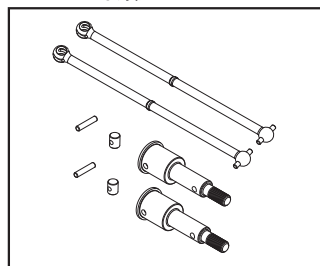

PD9205 REAR UNIVERSAL SHAFT
後輪傳動軸

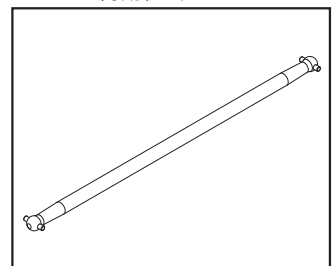

PD9206 CENTER DRIVE DOG BONE
中央傳動軸

SPARROWHAWK XXT PARTS LIST 零件表

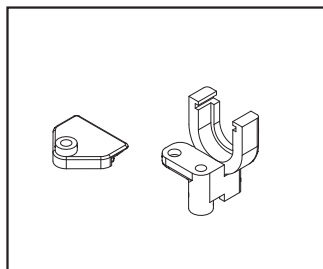

PD9207 CENTER BULKHEAD
軸承座

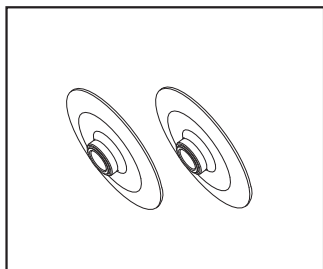

PD9210 SLIPPER HUB SET
限滑夾片組

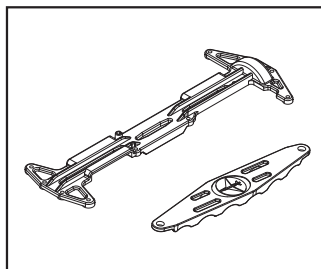

PD9211 TOP PLATE & BATTERY LID
二樓板+電池蓋板

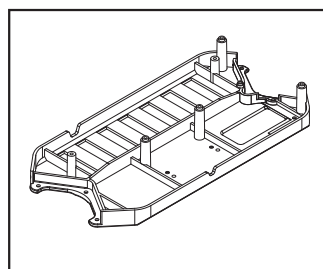

PD9212 CHASSIS
車底板

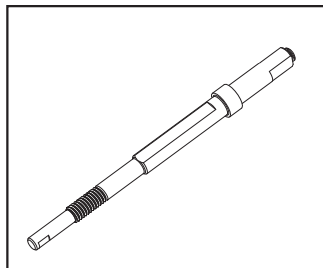

PD9213 MAIN SHAFT
主傳動軸

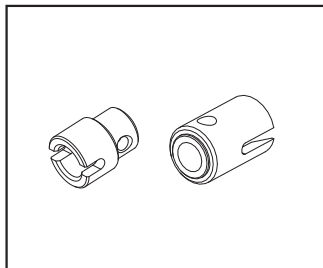

PD9215 OUTDRIVE CUPS
傳動軸套

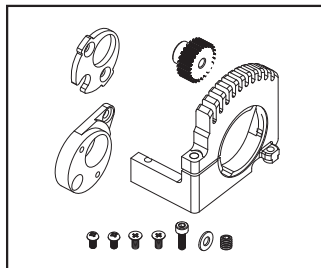

PD9269 MOTOR MOUNT
馬達固定座

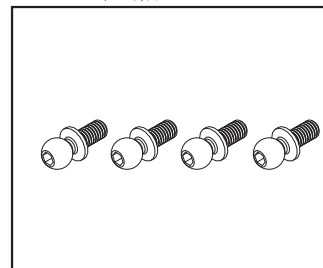

PD9217 BALL STUD
球頭座

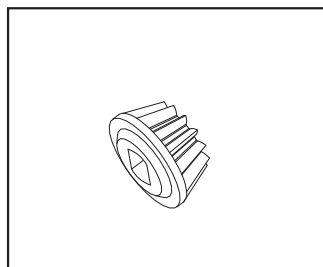

PD9219 SHAFT PINION GEAR 13T
差速小傘齒輪

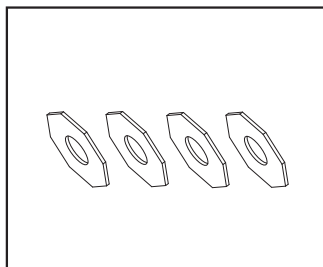

PD9222 SLIPPER PAD SET
限滑來令片組

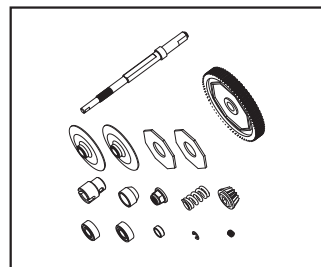

PD9223 SLIPPER CLUTCH SET
扭力限制組

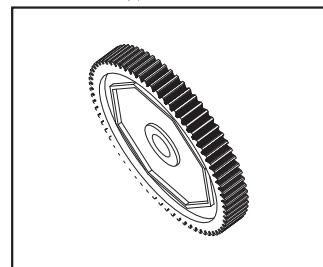

PD9224 MAIN GEAR 72T
傳動大齒輪

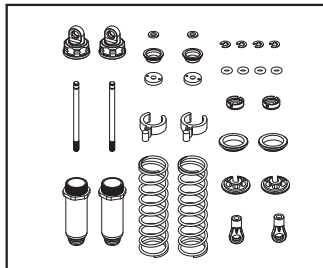

PD9265 RR SHOCK SET
後避震器組

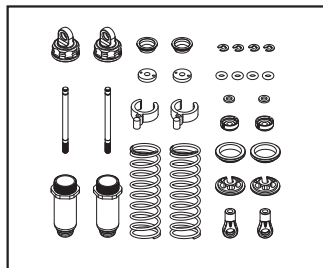

PD9266 FRONT SHOCK SET
前避震器組

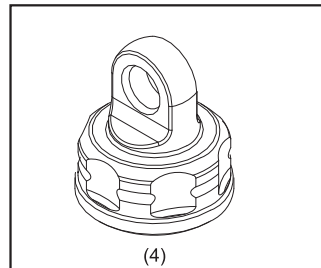

PD9267 SHOCK CAP(4)
避震器上固定頭

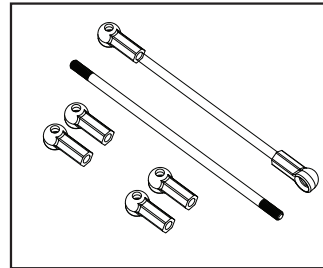



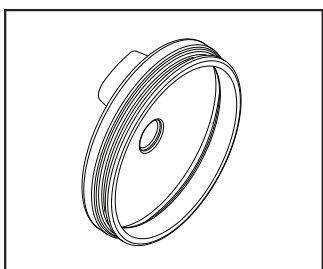











PD9268 STEERING LINK SET
轉向拉桿組

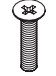

PD9270 MOTOR BOOT
馬達防塵套

SPARROWHAWK XXT PARTS LIST 零件表

	PD1713 Ø1xR4 (20)		PD0982 HNJ-1 (20)		PD1199 Ø3B (20)		PD1562 4mm (20)
R CLIPS R型插銷		NYLON STRAP 固定束帶		WASHER, 3mm 平墊圈		LOCK NUT, FLANGE 尼龍墊圈螺帽	
	PD7314 M3x12S (20) PD7475 M3x10B (10)		PD0961 M3x3B (20) PD1962 M3x4B (20) PD0962 M4x3B (20) PD1598 M4x4B (20)		PD1244 3mm (10)		PD1569 Ø2.5mm(20)
SK H.M. SCREW 內六角螺絲		SET SCREWS 無頭內六角螺絲		LOCK NUT, BLACK 3mm 止鬆螺帽(黑) 3mm		E-CLIP, 2.5mm E型扣環	
	PD7942 M3x8B (20)		PD9186 M3x8B (20) PD1683 M3x10B (20)		PD6576 M3x4B (20) PD9218 M3x12 (20)		PD7441 d8xD14xW4 (4) PD7466 d5xD11xW4 (10) PD9129 d10xD15xW4 (4) PD9130 d5xD8xW2.5 (4)
B P.T. SCREW w/W 墊圈自攻螺絲		BT P.M. SCREW W/WASHER 圓頭十字墊圈螺絲		BT MACH. SCREW 半圓頭內六角螺絲		BALL BEARING 滾珠軸承	
	PD9133 M2x4B (20) PD8205 M3x6B (20) PD1532 M3x8B (20) PD1534 M3x12B (20) PD1535 M3x14B (20) PD1536 M3x16B (20) PD2488 M3x18B (20) PD0880 M3x25B (20)		PD1192 M3x10B (20) PD2487 M3x20B (20) PD7944 M3x5B (20) PD7996 M25x6B (20) PD9124 M25x12B (20)		PD9131 M26x10B(20)		
B P.M. SCREW w/W 圓頭十字螺絲		CT P.M. SCREW 平頭十字螺絲		CT P.T. SCREW 平頭十字自攻螺絲			

PART#	DESCRIPTION	中文名稱	NOTE
2343	BL MOTOR IBL36/33-540C	無刷馬達IBL36/33-540C	
PD0880	BT P.MACH. SCREW(20),M3*25	圓頭十字螺絲組(20),M3*25	
PD0961	SET SCREWS(20),M3*3	無頭內六角螺絲(20),M3*3	
PD0962	SET SCREWS(20),M4*3	無頭內六角螺絲(20),M4*3	
PD0982	NYLON STRAP(20),SMALL	固定束帶	
PD1192	CTP.M.SCREW(20),M3*10	平頭十字螺絲(20),M3*10	
PD1199	WASHER(20),3mm	平墊圈(20),3mm	
PD1244	LOCK NUT,BLACK 3mm	止鬆螺帽(黑) 3mm	
PD1532	BT P.M. SCREW(20),M3*8	圓頭十字螺絲,M3*8	
PD1534	BT P.M. SCREW(20),M3*12	圓頭十字螺絲,M3*12	
PD1535	BT P.M. SCREW(20),M3*14	圓頭十字螺絲,M3*14	
PD1536	BT P.M. SCREW(20),M3*16	圓頭十字螺絲,M3*16	
PD1562	LOCK NUT(20),FLANGE M4	尼龍墊圈螺帽	
PD1569	E-CLIP(20),2.5mm	E型扣環(20),2.5mm	
PD1598	SET SCREWS(20),M4*4	無頭內六角螺絲(20),M4*4	
PD1683	BT P.M. SCREW W/W(20),M3*10	圓頭十字墊圈螺絲(20),M3*10	
PD1713	HOOK PIN (R) BAG	R型插銷零件包	
PD1962	SET SCREWS(20),M3*4	無頭內六角螺絲(20),M3*4	
PD2487	CT P. M.SCREW(20),M3*20	平頭十字螺絲(20),M3*20	
PD2488	BT P.M. SCREW(20),M3x18	圓頭十字螺絲(20),M3x18	
PD6606	TIRES W/FOAM, SST	輪胎零件包	
PD6756	BT M. SCREW(20),M3x10	半圓內六角螺絲(20),M3x10	
PD7036	MOTOR PINION GEAR,22T	馬達驅動齒輪22齒	
PD7314	SK H.M.SCREW(20),M3*12	內六角螺絲(20),M3*12	
PD7441	B.BEARING (4), 8*14*4	滾珠軸承零件包	
PD7466	BALL BEARING,(10),11*5*4	滾珠軸承零件包	
PD7475	SK H.M SCREW (20),M3*10	內六角螺絲(20),M3*10	
PD7712	ANTENNA BAG	天線管零件包	
PD7725	OP TURNBUCKLE SET	改裝拉桿組	
PD7727	REAR WING MOUNT	上尾翼支架組	
PD7733	FR SHOCK REPAIR KIT	避震器維修組(前)	
PD7734	RR SHOCK REPAIR KIT	避震器維修組(後)	
PD7735	INNER HINGE PIN SET	擺臂插銷組	
PD7736	SUSP. ARM MOUNT BUSHING	擺臂軸套	
PD7846	SERVO MOUNT, PR	伺服機座	
PD7901	FRONT BULK SET	前差速箱上下蓋組	
PD7902	REAR BULK SET	後差速箱上下蓋組	
PD7905	DIFF SPUR GEAR 44T	差速大傘齒	
PD7915	FRONT TOE PLATE	前投影板	
PD7916	REAR TOE PLATE	後投影板	
PD7922	STEERING SERVO HORN SET	轉向拉桿緩沖組	
PD7931	BUMPER	前防撞板	
PD7936	SHOCK TOWER SET	避震器支架	
PD7938	REAR WING MOUNT	尾翼支架	
PD7942	BT P.T SCREW w/W(20) ,M3*8	墊圈自攻螺絲(20) ,M3*8	
PD7944	CT P.M.SCREW(20),M3*5	平頭十字螺絲(20),M3*5	
PD7971	SWING RACK SET	轉向曲柄組	
PD7973	DRIVE PINION SET 13T	差速小扇齒	
PD7975	SHOCK MOUNT	避震器固定塊	
PD7976	BODY POSTS	車殼支柱	
PD7977	FRONT SUSP. ARMS	前擺臂組	
PD7978	REAR SUSP. ARMS	後擺臂組	
PD7984	TRUCK WHL (BLACK)	輪轂組	
PD7994	INNER HINGE PIN SET	擺臂銷組	
PD7996	CT P.M.SCREW(20),M25*6	平頭十字螺絲(20),M25*6	
PD7998	BULK LOWER COVER	差速箱下蓋版	
PD8091	SHOCK BUTTOM CAP	避震器下固定帽	
PD8092	SHOCK INNER SPACER	背托環	
PD8093	SHOCK BLADDER	空氣活門	
PD8097	SHOCK INN O-RING	避震器下O型環	

PART#	DESCRIPTION	中文名稱	NOTE
PD8098	BSHOCK PISTON	避震器活塞	
PD8205	HP SCREW(20),M3*6	圓頭十字螺絲(20),M3*6	
PD9051	DIFFERENTIAL CASE	差速器本體	
PD9055-1	DIFFERENTIAL GEAR SET	差速器齒輪	
PD9077	STEERING BLOCK SET	轉向臂	
PD9078	CASTER BLOCK SET	C型座組	
PD9087	SWING POST SCREW	轉向軸	
PD9090	HUB CARRIER SET	後輪座	
PD9102	SHOCK ACCESSORIES	避震器配件	
PD9103	SHOCK EYELET	避震器球頭拉桿	
PD9104	BALL STUD	球頭座	
PD9124	CT P.M.SCREW(20),M25*12	平頭十字螺絲(20),M25*12	
PD9129	BALL BEARING(4),10*15*4	滾珠軸承	
PD9130	BALL BEARING(4),5x8x2.5m	滾珠軸承	
PD9131	CT P. T.SCREW(20),M26*10	平頭十字自攻螺絲(20),M26*10	
PD9133	BT P. TAP SCREW(20),M2*4	圓頭十字螺絲(20),M2*4	
PD9186	BT P.M. SCREW W/W(20),M3*8	圓頭十字墊圈螺絲(20),M3*8	
PD9201	OUTDRIVE CUPS	傳動軸套	
PD9203	ALUM HEX DRIVE	輪殼轉換器	
PD9204	FRONT UNIN SHAFT	前輪傳動軸	
PD9205	REAR UNIN SHAFT	後輪傳動軸	
PD9206	CTR DRIVE DOG BONES	中央傳動軸	
PD9207	CTR BULKHEAD	中央軸承座組	
PD9210	SLIPPER HUB SET	限滑夾片組	
PD9211	TOP PLT&BATT STRAP	二樓板+電池蓋板	
PD9212	CHASSIS	車底板	
PD9213	MAIN SHAFT	主傳動軸	
PD9224	MAIN GEAR 72T	傳動大齒輪	
PD9215	OUTDRIVE CUPS	傳動軸套	
PD9217	BALL STUD	球頭座	
PD9218	BT M. SCREW(20),M3x12	半圓頭內六角螺絲	
PD9219	DR. PINION GEAR 13T	差速小傘齒輪	
PD9222	SLIPPER PAD SET	限滑夾片組	
PD9223	SLPR CLUTCH SET	扭力限制組	
PD9265	RR SHOCK SET	後避震器組	
PD9266	FR SHOCK SET	前避震器組	
PD9267	SHOCK CAP(4)	避震器上固定頭	
PD9268	STEERING LINK SET	轉向拉桿組	
PD9269	MOTOR MOUNT	馬達固定座	
PD9270	MOTOR BOOT	馬達防塵套	

SPARROWHAWK XXT OPTION PARTS LIST 改裝配件

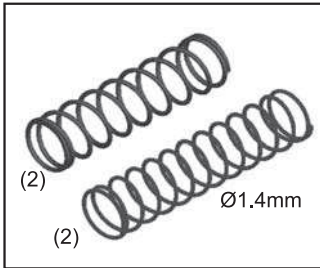

PD7721-B SHOCK SPRING(B)
避震器彈簧組(黑)

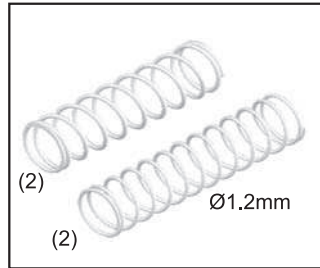

PD7721-W SHOCK SPRING(W)
避震器彈簧組(白)



PD7722 ALUM*STEERING BLOCK SET
鋁合金改裝轉向臂



PD7723 ALUM*CASTER BLOCK SET
鋁合金改裝C型座組



PD7724 ALUM*HUB CARRIER SET
鋁合金改裝後輪座

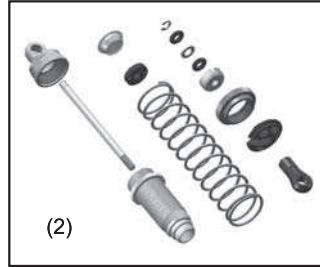

PD7728 FRONT ALUM*SHOCK SET
前鋁合金避震器組

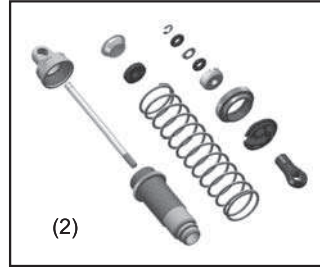

PD7729 REAR ALUM*SHOCK SET
後鋁合金避震器組

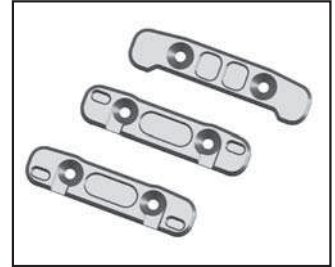

PD7730 ALUM*TOE PLATE SET
改裝件投影板

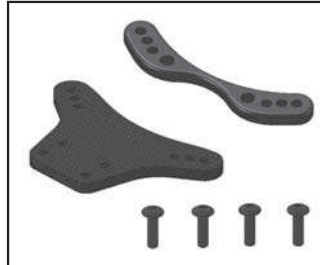

PD7957-1 CFRP*FRONT SHOCK TOWER
碳纖維前避震器支架板

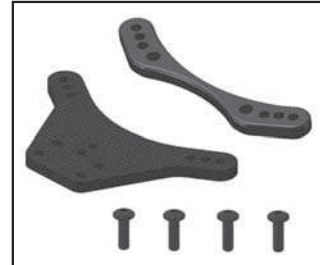

PD7958-1 CFRP*REAR SHOCK TOWER
碳纖維後避震器支架板



PD7965-1 SWAY BAR SET(GOLD)
防傾桿組(金)



PD7965-2 SWAY BAR SET(BLACK)
防傾桿組(黑)



PD7967 CFRP*BULK LWR COVER
碳纖維差速箱下蓋板



PD7968 ALUM*STEERING BELLCRANK
鋁合金改裝轉向搖臂



PD7969 ALUM*STEERING SLIDER
鋁合金改裝轉向曲柄

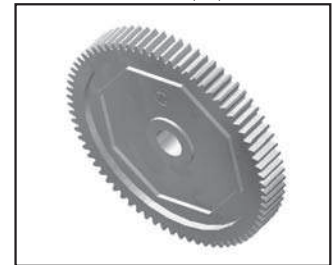

PD9214 MAIN GEAR,70T70
傳動大齒輪,70T



PD9226 CFRP*CHASSIS
碳纖維車底板



PD9227 CFRP*TOP PLATE
碳纖維二樓板



PD9228 CFRP*BATT. STRAP
碳纖維電池蓋板



PD9229 CFRP*BATTERY TRAP ACCS.
碳纖維車殼附件組



PD9230 ALUM*MOTOR MOUNT
改裝馬達固定座



PD9231 ALUM*TOP PLATE BRACE SET
鋁合金二樓板墊片組



PD9233 CHASSIS SUPPORT
底板支柱



PD9234 TITANIUM TURNBUCKLE SET
鈦合金改裝拉桿組

SPARROWHAWK XXT OPTION PARTS LIST 改裝配件



PD9235 TITANIUM STEERING LINK SET
鈦合金改裝轉向拉桿組

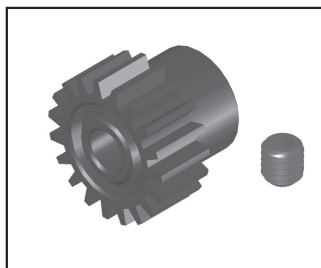

Motor Pinion Gear 馬達驅動齒

PD7033 19T
PD7034 20T
PD7035 21T
PD7036 22T
PD7037 23T
PD7038 24T
PD7039 25T
PD7836 26T



1340 ROTATING CAR STAND(ORANGE)
車用旋轉工作台(橘)



AQ1712 BLC ESC Setting Card
無刷馬達速度控制器設定版

※ CFRP=CARBON FIBER REINFORCED PLATE

※ ALUM=ALUMINUM

PART#	DESCRIPTION	中文名稱	NOTE
PD7033	MOTOR PINION GEAR,19T	馬達驅動齒輪19齒	
PD7034	20T 48P PINION GEAR	馬達驅動齒輪22齒	
PD7035	MOTOR PINION GEAR,21T	馬達驅動齒輪21齒	
PD7037	MOTOR PINION GEAR,23T	馬達驅動齒輪23齒	
PD7038	MOTOR PINION GEAR,24T	馬達驅動齒輪24齒	
PD7039	MOTOR PINION GEAR,25T	馬達驅動齒輪25齒	
PD7721-B	SHOCK SPRING (BLACK)	避震器彈簧組(黑)	
PD7721-W	SHOCK SPRING (WHITE)	避震器彈簧組(白)	
PD7722	ALUM STEERING BLOCK SET	鋁合金改裝轉向臂	
PD7723	ALUM CASTER BLOCK SET	鋁合金改裝C型座組	
PD7724	ALUM HUB CARRIER SET	鋁合金改裝後輪座	
PD7728	F. AL SHOCK BODY SET	前鋁合金避震器套筒組	
PD7729	R. AL SHOCK BODY SET	後鋁合金避震器套筒組	
PD7730	ALUM TOE FLATE SET	改裝件投影板	
PD7836	MOTOR PINION GEAR,26T	馬達驅動齒輪26齒	
PD7957-1	CFRP FR SHOCK TOWER	碳纖維前避震器支架板	
PD7958-1	CFRP RR SHOCK TOWER	碳纖維後避震器支架板	
PD7965-1	SWAY BAR SET (GOLD)	防傾桿組	
PD7965-2	SWAY BAR SET (BLACK)	防傾桿組	
PD7967	CFRP BULK LWR COVER	碳纖維差速箱下蓋板	
PD7968	ALUM STEERING BELLCRANK	鋁合金改裝轉向搖臂	
PD7969	ALUM STEERING SLIDER	鋁合金改裝轉向曲柄	
PD9214	MAIN GEAR 70T	傳動大齒輪	
PD9226	CFRP CHASSIS	碳纖維車底板	
PD9227	CFRP TOP PLATE	碳纖維二樓板	
PD9228	CFRP BATT. STRAP	碳纖維電池蓋板	
PD9229	BATTERY STRAP SET	電池固定組	
PD9230	ALUM MOTOR MOUNT	馬達固定座	
PD9231	AL TOP PLT BRC SET	二樓板墊片組	
PD9233	CHASSIS SUPPORT	底板支柱	
PD9234	TI TURNBUCKLE SET	改裝拉桿組	
PD9235	TI ST LINK SET	改裝轉向拉桿組	
1340	ROTATING CAR STAND, ORANGE	車用旋轉工作台,橘	
AQ1712	BLC ESC Setting Card	無刷馬達速度控制器設定版	

WHEEL & TIRE OPTION PART LIST 輪胎與輪殼

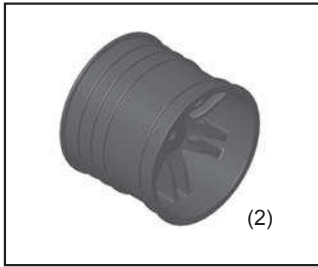

PD7715-O TRUCK WHEEL (ORANGE)
輪殼組 (橙色)

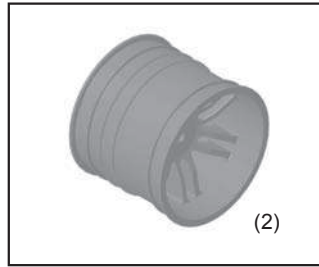

PD7715-Y TRUCK WHEEL (YELLOW)
輪殼組 (黃色)

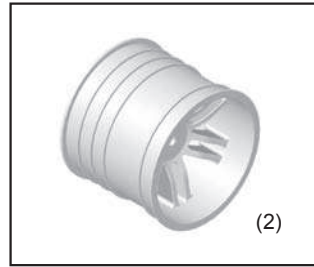

PD7715-W TRUCK WHEEL (WHITE)
輪殼組 (白色)

PART#	DESCRIPTION	中文名稱	NOTE
PD7715-O	TRUCK WHEEL (ORANGE)	輪殼組 (橙色)	
PD7715-Y	TRUCK WHEEL (YELLOW)	輪殼組 (黃色)	
PD7715-W	TRUCK WHEEL (WHITE)	輪殼組 (白色)	

BODY SHELLS 車殼



PD7732-B REAR WING(BLACK)
尾翼(黑)



PD7732-O REAR WING(WHITE)
尾翼(白)



PD7732-Y REAR WING(YELLOW)
尾翼(黃)



PD7732-W REAR WING(WHITE)
尾翼(白)



PD8363-GY/B PRINTING BODY(GY/B)
車殼組(灰/黑)

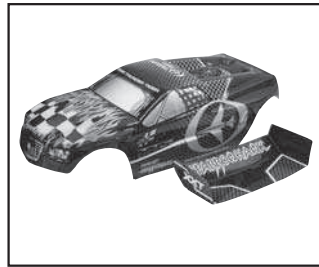

PD8363-L/B PRINTING BODY(L/B)
車殼組(藍/黑)

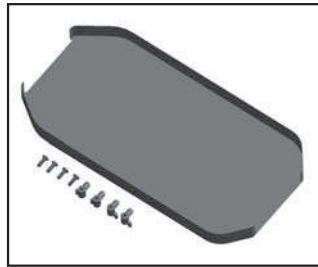

PD9232 CHASSIS COVER
車底護板

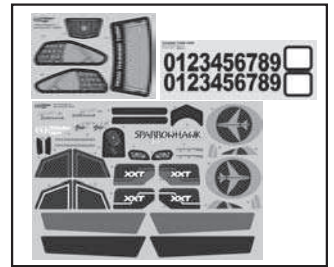

PD9263 BODY DECAL SET
彩貼組

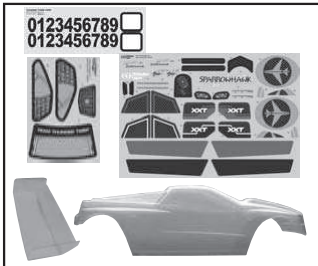

PD9264 CLEAR BODY W/DECAL
透明車殼及彩貼組

PART#	DESCRIPTION	中文名稱	NOTE
PD7732-B	REAR WING (BLACK)	尾翼(黑)	
PD7732-O	REAR WING (ORANGE)	尾翼(橘)	
PD7732-Y	REAR WING (YELLOW)	尾翼(黃)	
PD7732-W	REAR WING (WHITE)	尾翼(白)	
PD8363-GY/B	PNTD BODY (GRAY/BLACK)	完成車殼(灰/黑)	
PD8363-L/B	PNTD BODY (BLUE/BLACK)	完成車殼(藍/黑)	
PD9232	CHASSIS COVER	車底護板	
PD9263	BODY DECALS	彩貼組	
PD9264	CLEAR BODY W/DECAL	透明車殼及彩貼組	

OPTIONAL ELECTRONICS 選配電子產品



7.2V Ni-MH Battery Pack / Stick 電池



No.2941 Ni-MH Battery Pack/Flat, 7.2V/3600mAh SC



No.2937 Ni-MH Battery Pack/Flat, 7.2V/2400mAh SC

ACE RC®

Electronic Speed Control 速控器



No.8061 BLC-75C ESC



No.8060 BLC-40C ESC

Specifications

STAND-ALONE ESC	BLC-75C ESC	BLC-40C ESC
Item Number	8061	8060
NiCD / NiMH cells	7.2V	7.2V
Li Polymer cells	7.4-11.1V	7.4-11.1V
Current (Continuous)	75A	40A
Max Output	540W/60sec	360W/40sec
Size LxWxH(mm)	37x28.8x36.5	46x28.8x31.5
Weight (g)	80.3g	66g

COMBO SYSTEM	BLC-75C PWR	BLC-40C PWR
BLS PWR Combo No	8057	8056
Included Motor KV	6100kv	4900kv
Motor Fan		●
ESC Setting Card	●	●
Brushless Motor	●	●
ESC	●	●

RIPPER



No.2360 IBL36/61-540C 6100 RPM/Volt



No.2359 IBL36/49-540C 4900 RPM/Volt

ACE RC®

Receiver 接收機



AQ2280 2.4GHz 4CH Receiver

Specifications

Receiver	TRS401ss
Item No.	AQ2280
Frequency (GHz)	2.4GHz
Channel	4CH
BEC	No
Type	PPM
Antenna Type	Single Antenna
Battery Power	4.8~6V
Dimension(mm)	18.3x35.6x14.2mm
Weight(g/oz)	6.5g



2.4GHz Surface Radio Control System 數位槍型遙控器 No.8308



Specifications

Item No.	8308
Transmitter	COUGAR PS3i
Configuration	Pistol Grip
Encoder	3Ch
Frequency(MHz)	2.44GHz
Modulation	GFSK
Current Drain	130mA@9.6V
Frequency Band Width	24MHz
Transmission System	FHSS
Band No.	78CH
ID No.	13bit
Radio Speed	16Kbps
Servo Reverse	CH1~CH3
Display	LCD
Mode Memory	10
Antenna Type	1/4_Dipole Sleeve
Antenna Peak Gain	2dBi Typical
Power Requirement	9.6V/8 cell AA Battery
Dimension (w/o Antenna)	220x99x182mm / 8.66x3.89x7.16in
Weight (g/oz)	443g/15.59oz



AQ2271AC ACE RC 2.4GHz TX RF Module, JR*



AQ2254AC ACE RC 2.4GHz TX RF Module, Futaba*

* Futaba and JR are registered trademarks.

ACE RC®

Digital Servo 數位伺服機



No.8127 Digital High Torque / DS1015



No.8128 Digital Standard / DS1313

Specifications

Torque 4.8V/6V(oz-in)	161.1 / 201.4
Torque 4.8V/6V(Kg-cm)	11.6 / 14.5
Speed 4.8V/6V(sec/60°)	0.138 / 0.108
Gear	M
Bearing	2BB
Size LxWxH(in)	1.65 x 0.81 x 1.56
Size LxWxH(mm)	41.8 x 20.6 x 39.6
Weight(oz/gram)	2.328 / 66

Specifications

Torque 4.8V/6V(oz-in)	133.3 / 173.6
Torque 4.8V/6V(Kg-cm)	9.6 / 12.5
Speed 4.8V/6V(sec/60°)	0.16 / 0.13
Gear	M
Bearing	2BB
Size LxWxH(in)	1.65 x 0.81 x 1.56
Size LxWxH(mm)	41.8 x 20.6 x 39.6
Weight(oz/gram)	2.328 / 66

